

We recommend you hire an experienced finish carpenter or floor installer to achieve quality results with all Duchateau® Wall Coverings. The right tools are key for a successful installation.

## RECOMMENDED TOOLS:

- 23 Gauge Nail Gun
- 18 Gauge Nail Gun
- Glue Applicator and Titebond II Glue or similar (for edges)
- Construction Glue (Liquid Nails or similar)—use between the back panel and the drywall or OSB and for hardboard area
- Jigsaw\* to open outlet spaces
- Laser
- Chalk Line
- Countersink Bit (if you use flathead screws on the back panel)
- Finish Miter Saw\*—we recommend a Dewalt that has a horizontal capacity of 16”
- Finish Table Saw\*
- Air Compressor
- Step Ladder or Scaffold, if necessary
- Rubber Mallet
- Drill
- Measuring Tape
- Ruler and Scoring Knife
- Black Paint, Tray and Roller
- Black Tape (for edges and joints in lieu of paint)

\*Make sure your knives are in prime condition to work with pre-finished lumber and wood veneers.

## RECOMMENDATIONS TO BEGIN:

- We recommend you paint the walls where you will apply the products with Matte Black Paint to make any gaps less noticeable.
- Arrange 1 to 2 rows of the Duchateau wall covering tiles on the floor. This will allow you to see your pattern and define your cuts. Mark your floor outlets.
- Duchateau wall covering tile walls can be installed in a Vertical or Horizontal direction. Installation at any other angle is also acceptable although more waste is created.
- Make sure you check if your walls are aligned from floor to ceiling. Once this is checked, we recommend you draw a straight line that you will follow as a guide. Draw the lines vertically and horizontally to determine a starting point and create your guidelines. We recommend the use of a Laser and Chalk line to draw your starting lines.
- Allow ¼” gap all around your installation area. This is between Duchateau wall covering tiles and ceiling or crown, between tiles and floor or baseboard and on the edges next to a wall or on a corner. Use shims if necessary. This will allow for product expansion and contraction.
- Any wood trim used with the Duchateau wall covering tiles should become part of the panels and the ¼” gap should be left after the trim.

## INSTALLATION INSTRUCTIONS A (CURVA, KRESCENT, KUADRA, PARALLELS, VERTEX STYLES):

1. Always start from the bottom. If starting from Left to Right, place the viewable hardboard back panel to the right (If you start from Right to Left, the hardboard back panel should be on the Left).
2. The back panel area can have as many nails as needed (at least 4 on each hardboard area).
3. The use of flathead screws are also an option as long as you use a Counter Sink bit first and then drill in the flat head screws. If you start from Right to Left, place the back panel to the Left. If possible, make sure nails or screws in the back panel go lower than the back panel to avoid having those elements throw the interlocking wall covering tiles out of line.
4. Duchateau wall covering tiles can also be centered with the wall; in that case you can place the back panel in either direction and make the adjustments at the ends. Make sure you keep the pieces you cut off as these pieces can be used on the other side if needed.
5. The panels must be glued and nailed for the warranty to apply; the combination of both elements will be helpful during installation and will also prevent the panels from warping in the future. Use a good amount of construction adhesive on the back panel.
6. We also recommend the use of a small amount of Adhesive on the areas where the back panel is visible and the pieces will interlock on top. Use a very small amount, and not very close to the edges, to avoid glue spreading over the Duchateau wall covering tiles.
7. Use #18 Gauge Nails for more strength on the edge of the panels and on the hardboard.
8. Use #23 Gauge Nails on the center areas of your tile—the finished viewable areas.
9. As you assemble the tiles, make sure they are assembled tight. Use a rubber mallet and a scrap piece of wood to assist.
10. Apply the nails on the corners where parts of the tile itself intersect and in an upward angle on the lower part of the wall. At eye level areas, be very careful how you use the #23 Gauge Nails and make sure they go through exactly on intercepting corners to avoid visible nails on the Duchateau wall covering tiles and on the upper areas of the wall. Nail through the top corners. You can also nail on the face at intersecting corners, but use a downward angle. Make sure the nails go through the wood. Use adequate pressure on the Nail Gun.

## INSTALLATION INSTRUCTIONS B (EDGE, INFUSE, KUBIK STYLES):

1. Make sure you use a Scoring Knife for every cut over veneers. Use finish veneer blades in good condition for all cuts.
2. You can start from the top or the bottom. Make sure you analyze how many Duchateau wall covering tiles you will need and try to avoid cutting the solid, 3-D elements of the Duchateau wall covering tile on the top or the bottom. We recommend you lay out the wall covering tiles on the floor first.
3. The panels must be glued and nailed for the warranty to apply; the combination of both elements will be helpful during installation and will also prevent panels from warping in the future. You can use #18 Gauge Nails on the edge of the panels. On the lower parts of your wall, you can use #23 Gauge Nails on the intersections between the veneer area and solid elements. Make sure you nail in an upward angle. At eye level areas, use only #18 Nails on the edges of the panel all around. On the upper areas of the wall, you can also nail through corners, but use a downward angle on the top areas that will not be visible. Make sure the nails go through the wood to avoid interlocking problems. Use adequate pressure on your nail guns.

**IMPORTANT:** Do not nail through the veneer of the Duchateau wall covering tiles. The nails will be very visible and difficult to touch up.

We also recommend the use of a very small amount of Construction Adhesive on the edges where the wall covering tiles will intercept. Make sure you apply this on the lower part of the edge to avoid the glue to spread over the finished veneer.

## SPECIAL APPLICATIONS:

### OUTLET CUTOFF:

- Mark your outlet distance and elevation on your test pattern and on the wall.
- Mark your tile and drill 4 holes for each corner of the outlet.
- Using a Jigsaw to cut a line from corner to corner.
- Turn the piece around, trim and detail.
- Test on wall before applying glue.

### FIREPLACES & HEATERS:

We do NOT recommend the use of Duchateau wall covering tiles around a Fireplace or a Heater. The Duchateau tiles are made with flammable materials. Check your local codes. In most areas, this is prohibited by code "A". Optional A Rating fire retardant is available for an additional fee.

### BATHROOMS:

Duchateau wall covering tiles may be used in bathrooms as long as they are NOT installed near or at splash areas.

### CEILING APPLICATIONS:

In general we **do not** recommend using these products for ceiling applications. Ceiling applications are not approved nor recommended with Curva, Krescent, Kuadra, Parallels, Wave, Arc Chevron, Curva Chevron, Scale or Vertex styles. If the Edge, Infuse or Kubik styles are used on a ceiling application, three #18 Gauge Nails (at least 1-1/4" long) should be used over each solid part of the tile as an extra precaution and must be installed by a Licensed Flooring Contractor or Licensed Finish Carpenter with ceiling installation experience. Special glues should be used and must be specified by the Project Engineer and/or signing Architect for the project and also combined with the use of #18 Gauge Nails along the edges of each tile.

### CONCRETE WALLS:

For installation over concrete walls, wood separators and OSB boards are recommended. Direct installation over concrete is not covered by the warranty.

## CUSTOM TRIMS:

- Duchateau can manufacture any custom trim you may need with the same wood species and finishes of Duchateau wall covering tiles (outlet trim, window trim, casing, baseboard, crown, etc.). Please contact us for a quote.
- We recommend trim products for the edges of our products. A rectangular 3/4" x 1" trim is available in 72" length.
- Duchateau wall covering tiles can be mitered on corners. Make sure you cut the parts at the same length on each side to ensure the 3-D heights match.
- As a secondary option for corners, we also offer a square 3/4" x 1" trim available in 72" length.

## Congratulations on your purchase of DUCHATEAU 3D Wood Wall Panels.

We strongly recommend you re an experienced finish carpenter or wood flooring installer to achieve quality installation results. The right tools and knowledge are the keys to successful installations.

### IMPORTANT:

Be sure to fully inspect shipment for any damage upon arrival, prior to beginning installation. Any damage must be reported immediately to [customerservice@duchateau.com](mailto:customerservice@duchateau.com)

### WARNING:

Improperly installing DUCHATEAU 3D Wood Wall Panels may result in voiding your warranty. Protect your warranty and investment by always fastening and gluing all DUCHATEAU 3D Wood Wall Panels.

## Recommended Tools

- Protective Floor Cover
- Level or Laser Level
- Chalk Line
- Construction Adhesive and Applicator
- Finish Table Saw
- Black Screws 6 X 1-1/4"
- Drill
- Countersink Bit
- Step Ladder or Scaffold if needed
- Rubber Mallet
- Measuring Tape, Rules and Scoring Knife

*NOTE: All saw blades must be in prime condition to work with pre-finished lumber.*

#### Step 1

Check that the wall is level and plumb. If not, note all differences in height and/or width, and adjust your layout accordingly.

Fix any irregularities on the surface of your installation area that might affect how the tiles will lay.

#### Step 2

Leave a 1/4" gap around the perimeter of your installation area, including any trim, to allow for product expansion and contraction. Use shims for an even separation if needed,

#### Step 3

Determine which direction you wish to install the tiles - horizontal, vertical or diagonal.

Lay two rows out on the floor before installing to plan your wall. Define and mark initial cuts.

**IMPORTANT:** If centered install is desired, mark center piece and measure out to ends of wall to ensure both sides are equivalent before cutting excess.

#### Step 4

Measure and mark horizontal and vertical guidelines matching your tile size using a laser level and chalk line

#### Step 5

To prepare for outlets, light switches or other items, arrange other rows of tiles that require additional cuts on the floor. Mark all cuts needed once level. See additional instructions for installing mouldings. Note that the final row may also need to be cut.

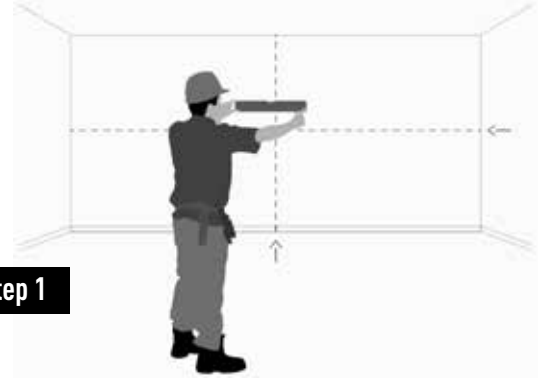

Step 1

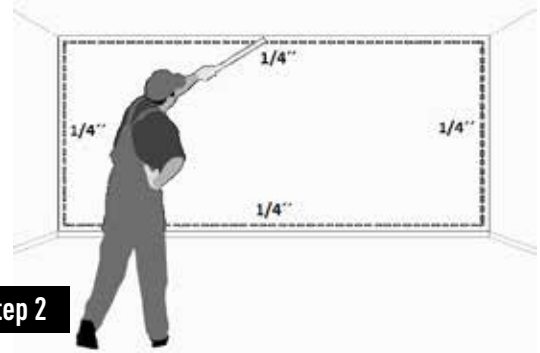

Step 2

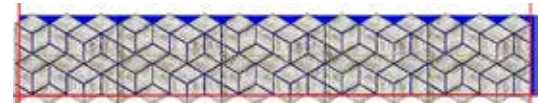

Step 3



Step 4

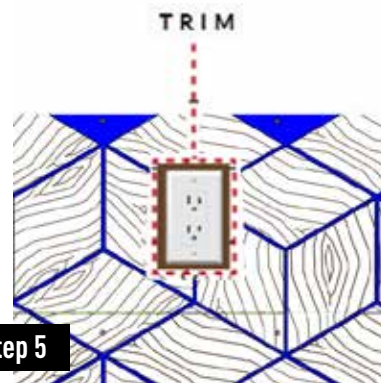

Step 5

#### Step 6

To install horizontally, begin in the left corner with the acrylic back panel facing the direction of the install. Define and mark initial cuts. (Sample cuts only are shown.)

Starting from the left (Figure A) place the visible acrylic back panel to the right. Starting from the right, (Figure B) place the visible acrylic back panel to the left.

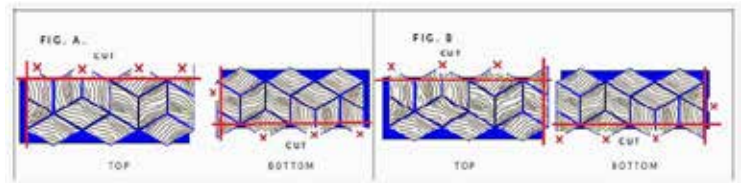

#### Step 6

#### Step 7

Cut off excess tab material from the tile in order to be flush with the edge of the install area. Please note that when cutting, some pattern pieces may fall off due to the vibration of the saw. If this happens, simply glue back on and then screw from back to secure it firmly.

#### Step 8

Add construction adhesive pellets on the back panel of the first tile. Be careful not to place adhesive in areas where the acrylic shows through from the front.

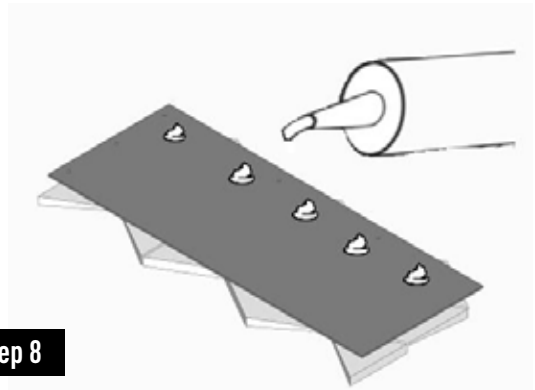

#### Step 8

Place the initial tile at the starting point of your installation.

#### Step 9

Once tile is level and aligned, fasten the exposed acrylic panel with black screw. (6 x 1 1/4") Be sure to use a counter-sink bit first to drill screws below the surface. Do not apply pressure to the screws, as it may damage the acrylic.

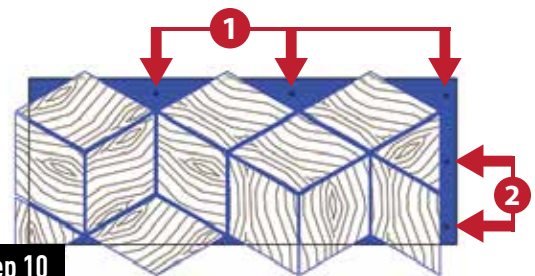

#### Step 10

#### Step 11

Fasten the top of the piece first with 3 screws. Then screw in the right side with 3 screws.

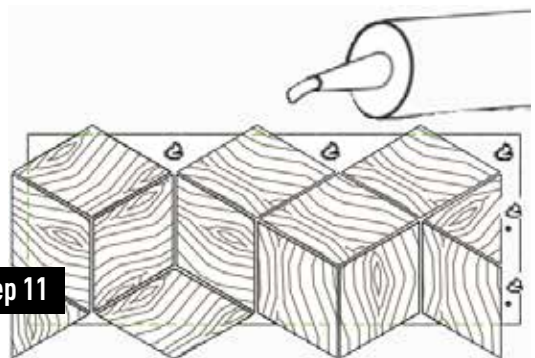

#### Step 11

#### Step 12

Now, apply construction adhesive in small balls to the exposed acrylic panel in preparation for the next tile.

#### Step 12

Carefully slide and fit the next adjacent tile under the previous tile. If necessary, use a rubber mallet and a scrap piece of wood to assist.

#### Step 13

Make sure each tile and row is level and plumb.

#### Step 14

Repeat the entire fastening process across the wall, making sure to cut any tiles to fit as you approach the end of the wall.

**REMEMBER:** The panels must be affixed with both glue and screws for our Warranty to apply. This also prevents panels from warping.

Step 13

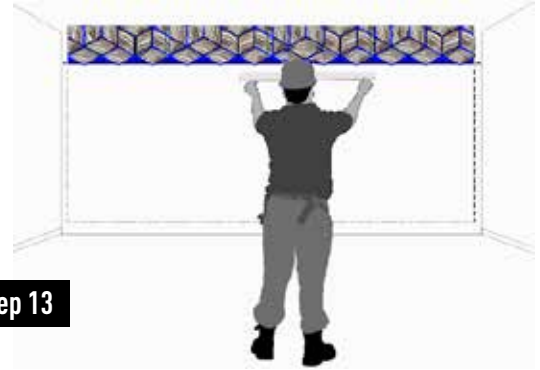

### Congratulations on your purchase of DUCHATEAU 3D Wood Wall Panels.

We strongly recommend you re an experienced finish carpenter or wood flooring installer to achieve quality installation results. The right tools and knowledge are the keys to successful installations.

#### IMPORTANT:

Be sure to fully inspect shipment for any damage upon arrival, prior to beginning installation. Any damage must be reported immediately to [customerservice@duchateau.com](mailto:customerservice@duchateau.com)

#### WARNING:

Improperly installing DUCHATEAU 3D Wood Wall Panels may result in voiding your warranty. Protect your warranty and investment by always fastening and gluing all DUCHATEAU 3D Wood Wall Panels.

### Recommended Tools

- Protective Floor Cover
- Level or Laser Level
- Chalk Line
- Construction Adhesive and Applicator
- Finish Table Saw
- Black Screws 6 X 1-1/4"
- Drill
- Countersink Bit
- Step Ladder or Scaffold if needed
- Rubber Mallet
- Measuring Tape, Rules and Scoring Knife

*NOTE: All saw blades must be in prime condition to work with pre-finished lumber.*



#### Step 1

Check that the wall is level and plumb. If not, note all differences in height and/or width, and adjust your layout accordingly.

Fix any irregularities on the surface of your installation area that might affect how the tiles will lay.

#### Step 2

Leave a 1/4" gap around the perimeter of your installation area, including any trim, to allow for product expansion and contraction. Use shims for an even separation if needed,

#### Step 3

Determine which direction you wish to install the tiles - horizontal, vertical or diagonal.

Lay two rows out on the floor before installing to plan your wall. Define and mark initial cuts.

**IMPORTANT:** If centered install is desired, mark center piece and measure out to ends of wall to ensure both sides are equivalent before cutting excess.

#### Step 4

Measure and mark horizontal and vertical guidelines matching your tile size using a laser level and chalk line

#### Step 5

To prepare for outlets, light switches or other items, arrange other rows of tiles that require additional cuts on the floor. Mark all cuts needed once level. See additional instructions for installing mouldings. Note that the final row may also need to be cut.

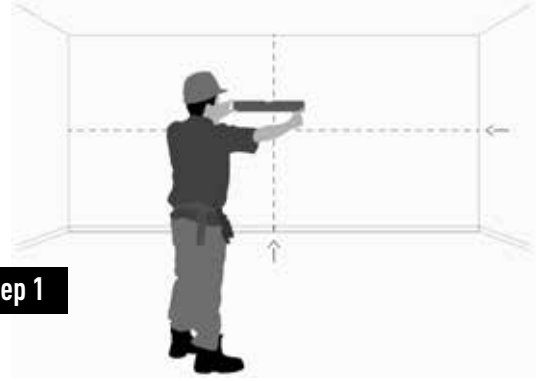

Step 1

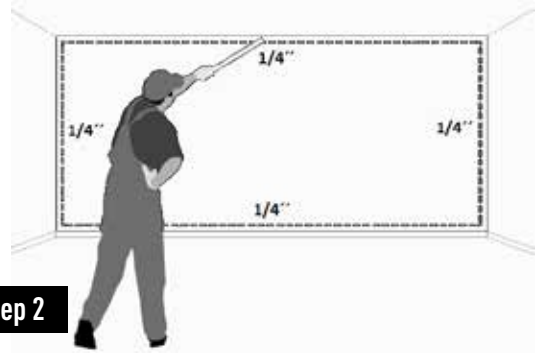

Step 2

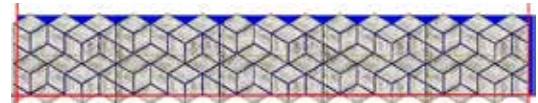

Step 3



Step 4

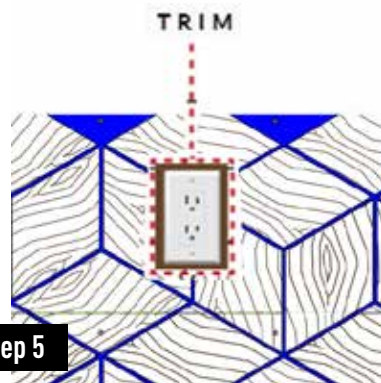

Step 5

#### Step 6

To install horizontally, begin in the left corner with the acrylic back panel facing the direction of the install. Define and mark initial cuts. (Sample cuts only are shown.)

Starting from the left (Figure A) place the visible acrylic back panel to the right. Starting from the right, (Figure B) place the visible acrylic back panel to the left.

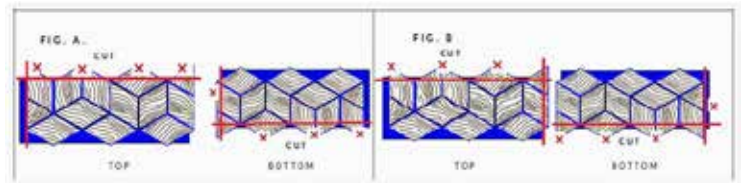

#### Step 6

#### Step 7

Cut off excess tab material from the tile in order to be flush with the edge of the install area. Please note that when cutting, some pattern pieces may fall off due to the vibration of the saw. If this happens, simply glue back on and then screw from back to secure it firmly.

#### Step 8

Add construction adhesive pellets on the back panel of the first tile. Be careful not to place adhesive in areas where the acrylic shows through from the front.

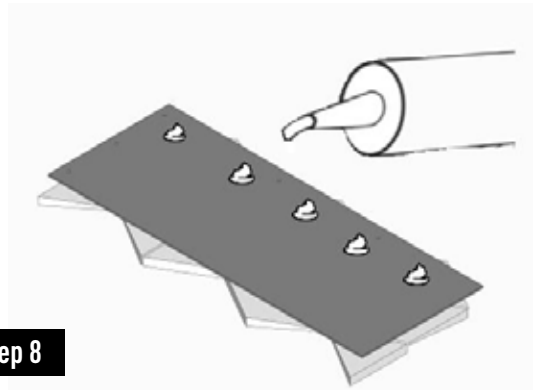

#### Step 8

Place the initial tile at the starting point of your installation.

#### Step 9

Once tile is level and aligned, fasten the exposed acrylic panel with black screw. (6 x 1 1/4") Be sure to use a counter-sink bit first to drill screws below the surface. Do not apply pressure to the screws, as it may damage the acrylic.

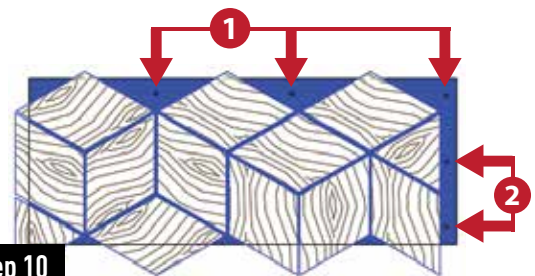

#### Step 10

#### Step 11

Fasten the top of the piece first with 3 screws. Then screw in the right side with 3 screws.

#### Step 11

Now, apply construction adhesive in small balls to the exposed acrylic panel in preparation for the next tile.

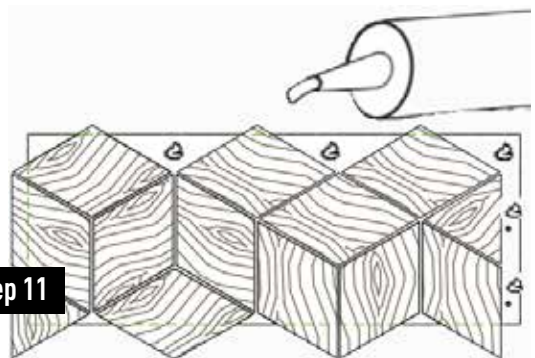

#### Step 11

#### Step 12

Carefully slide and fit the next adjacent tile under the previous tile. If necessary, use a rubber mallet and a scrap piece of wood to assist.

#### Step 13

Make sure each tile and row is level and plumb.

#### Step 14

Repeat the entire fastening process across the wall, making sure to cut any tiles to fit as you approach the end of the wall.

**REMEMBER:** The panels must be affixed with both glue and screws for our Warranty to apply. This also prevents panels from warping.

Step 13

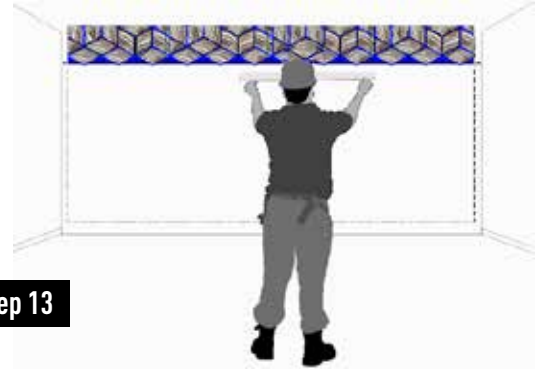

### Congratulations on your purchase of DUCHATEAU 3D Wood Wall Panels.

We strongly recommend you re an experienced finish carpenter or wood flooring installer to achieve quality installation results. The right tools and knowledge are the keys to successful installations.

#### IMPORTANT:

Be sure to fully inspect shipment for any damage upon arrival, prior to beginning installation. Any damage must be reported immediately to [customerservice@duchateau.com](mailto:customerservice@duchateau.com)

#### WARNING:

Improperly installing DUCHATEAU 3D Wood Wall Panels may result in voiding your warranty. Protect your warranty and investment by always fastening and gluing all DUCHATEAU 3D Wood Wall Panels.

### Recommended Tools

- Protective Floor Cover
- Level or Laser Level
- Chalk Line
- Silicone and Applicator
- Finish Table Saw
- Drill
- Countersink Bit
- Step Ladder or Scaffold if needed
- Rubber Mallet
- Measuring Tape, Rules and Scoring Knife

*NOTE: All saw blades must be in prime condition to work with pre-finished lumber.*

#### Step 1

Check that the wall is level and plumb. If not, note all differences in height and/or width, and adjust your layout accordingly.

Fix any irregularities on the surface of your installation area that might affect how the tiles will lay.

#### Step 2

Mark the position of the LED Lighting Strips using a pencil and a tape measure for accuracy. For line drawing, use a chalk line. For best illumination, at least three strips of lights the full length of the install area should be used.

#### LED Lighting Strip Information:

We recommend Philips Hue Lighting Plus Strips or equivalent  
1600 lumens, extendable up to 32 feet, extremely flexible



#### Step 3

Unpack the lighting strip(s) and assemble to the adapter, following manufacturer's guidelines. Plug in all lights to test.

#### Step 4

Peel and stick the transformer to the wall, following manufacturer instructions. Clean the wall, and then place the lighting strips on the wall according to manufacturer instructions. Note that corners should be 90° or less. Do not join lines or place the LED itself on corners or curves.

#### Step 5

With lighting installed, you can now begin installation of the panels. Please wear all appropriate safety equipment, including eye protection and gloves. Place a mat or other floor protection to protect wall panels.



Step 1



Step 2



Step 3

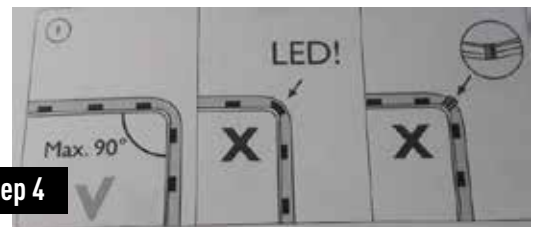

Step 4



Step 5

#### Step 6

The installation should start from bottom to top. To start in the lower right corner, you must cut the wood so that the acrylic covers the entire surface of the wall. To make the cut, use a table saw. The cut measurement should be calculated taking into account the total number of pieces to be placed on the wall.

#### Step 7

Make sure the first piece is level and plumb before affixing to wall. Then, using black 3" screws, screw in the top part of the panel. The screw must enter the pre-drilled hole in a straight line. Use a wooden stop block placed behind the acrylic at each screw. **You must screw slowly with light pressure to ensure you do not break or fracture the acrylic.**

#### Step 8

Screw the left side of the tile in using 3 screws. All screws should go in the pre-drilled holes on the acrylic flanges.

#### Step 9

Apply silicone using a Silicone Gun to the wood edge of the second tile. Apply in center of wood edge, and apply only on the wood.

#### Step 10

Place the tile next to the first tile, and repeat Steps 7-9. Following these steps, complete the first row of tiles.

#### Step 11

When the first row is completed, move on to the second row, following the same steps. Ensure that your screws do NOT pierce the lighting strips.

#### Step 12

Cut tiles as needed to complete wall. Test LED lights before placing final tile.



Step 6

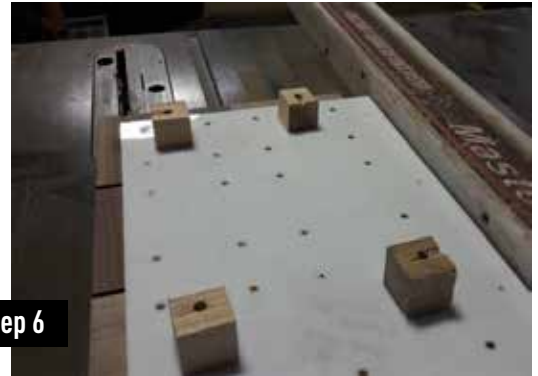

Step 6



Step 7



Step 9



Step 12

### Congratulations on your purchase of DUCHATEAU 3D Wood Wall Panels.

We strongly recommend you re an experienced finish carpenter or wood flooring installer to achieve quality installation results. The right tools and knowledge are the keys to successful installations.

#### IMPORTANT:

Be sure to fully inspect shipment for any damage upon arrival, prior to beginning installation. Any damage must be reported immediately to [customerservice@duchateau.com](mailto:customerservice@duchateau.com)

#### WARNING:

Improperly installing DUCHATEAU 3D Wood Wall Panels may result in voiding your warranty. Protect your warranty and investment by always fastening and gluing all DUCHATEAU 3D Wood Wall Panels.

### Recommended Tools

- Flat black paint
- Paint Tray
- Brush and Roller
- Protective Floor Cover
- Black Tape
- Level or Laser Level
- Chalk Line
- Construction Adhesive and Applicator
- Finish Miter Saw with a Horizontal Capacity of 16"
- Finish Table Saw
- Jigsaw
- 23 Gauge Nail Gun and Nails
- 18 Gauge Nail Gun and Nails
- Drill
- Air Compressor
- Step Ladder or Scaffold if needed
- Rubber Mallet
- Measuring Tape, Rules and Scoring Knife

### Optional

- Flathead Screws
- Countersink Bit

*NOTE: All saw blades must be in prime condition to work with pre-finished lumber.*

#### Step 1

Check that the wall is level and plumb. If not, note all differences in height and/or width, and adjust your layout accordingly.

Fix any irregularities on the surface of your installation area that might affect how the tiles will lay.

#### Step 2

Paint the desired installation area matte black to hide any potential gaps between or within tiles due to expansion and contraction over time. A 1/16" gap is normal between tiles.

For edges, use black tape to further conceal paint imperfections if needed.

#### Step 3

Leave a 1/4" gap around the perimeter of your installation area, including any trim, to allow for product expansion and contraction. Use shims for an even separation if needed,

#### Step 4

Determine which direction you wish to install the tiles - horizontal, vertical or diagonal.

Lay two rows out on the floor before installing to plan your wall. Define and mark initial cuts.

**IMPORTANT:** If centered install is desired, mark center piece and measure out to ends of wall to ensure both sides are equivalent before cutting excess.

#### Step 5

Measure and mark horizontal and vertical guidelines matching your tile size using a laser level and chalk line

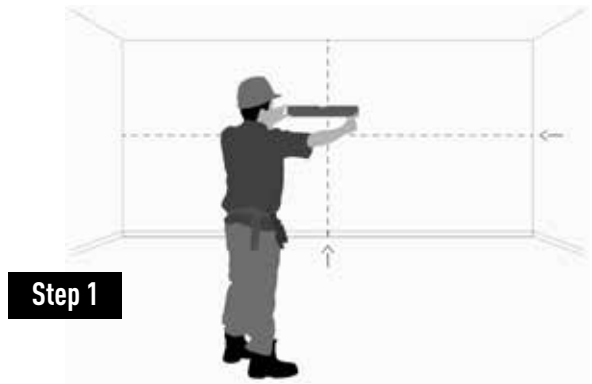

Step 1

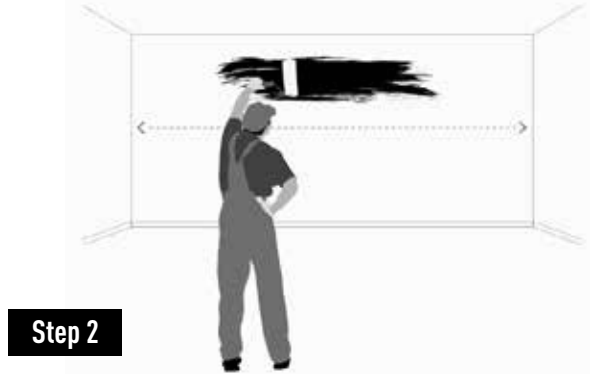

Step 2

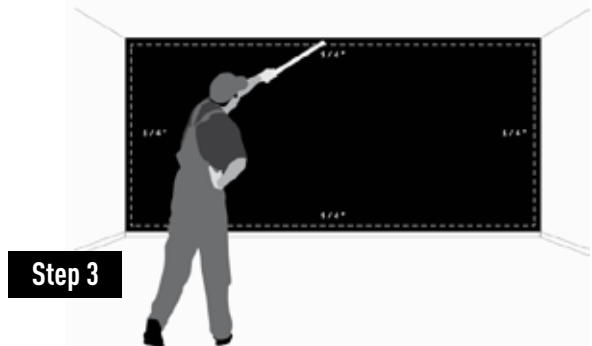

Step 3



Step 4

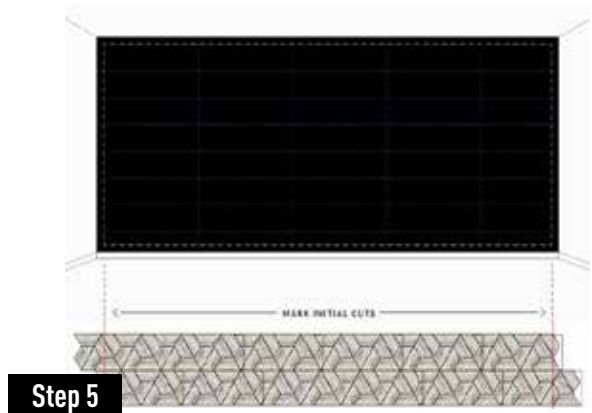

Step 5



#### Step 6

To prepare for outlets, light switches or other items, arrange other rows of tiles that require additional cuts on the floor. Mark all cuts needed once level. See additional instructions for installing mouldings. Note that the final row may also need to be cut.

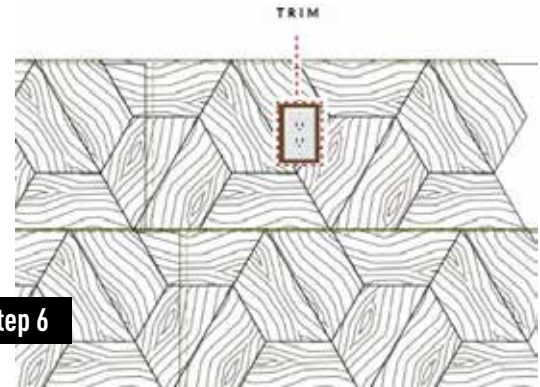

Step 6

#### Step 7

To install horizontally, begin in the left corner with the hardboard back panel facing the direction of the install. Define and mark initial cuts.

Starting from the left (Figure A) place the visible hardboard back panel to the right. Starting from the right, (Figure B) place the visible hardboard back panel to the left.

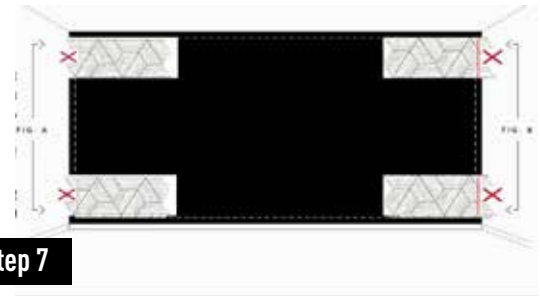

Step 7

#### Step 8

Cut off excess tab material from the tile in order to be flush with the edge of the install area. Please note that when cutting, some pattern pieces may fall off due to the vibration of the saw. If this happens, simply glue back on and then nail from back to secure it firmly.



#### Step 9

Add construction adhesive on the back panel of the first tile. Place the initial tile at the starting point of your installation.

#### Step 10

Once tile is level and aligned, fasten the exposed back panel with at least 4 #18 Gauge nails. (OPTIONAL: If using flathead screws, be sure to use a countersink bit first to drill holes below the surface.)

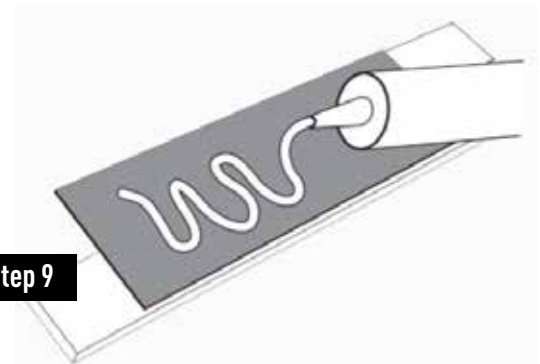

Step 9

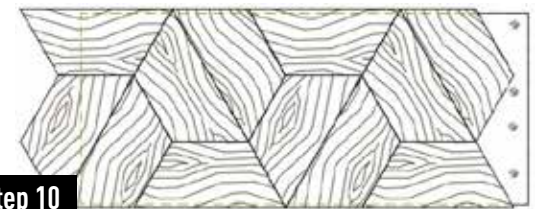

Step 10

#### Step 11

Apply pressure on the individual piece when nailing.  
Using #23 Gauge Nails, nail in between individual wood pieces, taking care to hide the nails within the 3D volume of each design.

When possible, do not nail on the face of each insert to maintain the finished aesthetic of the wall covering.

#### Step 12

Apply a very small amount of construction adhesive on the exposed hardwood panel in preparation for the next tile.

#### Step 13

Carefully slide and fit the next adjacent tile under the previous tile. If necessary, use a rubber mallet and a scrap piece of wood to assist.

Remember, a 1/16" separation is normal, as each handmade piece must be allowed to expand and contract.

#### Step 11

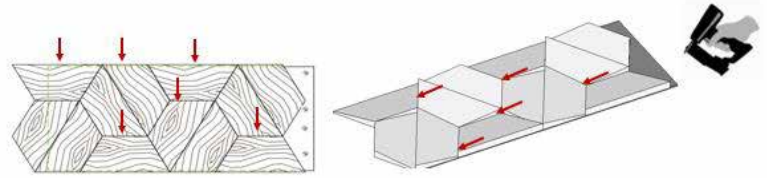

Above eye level, use 23 Gauge nails at a downward angle.

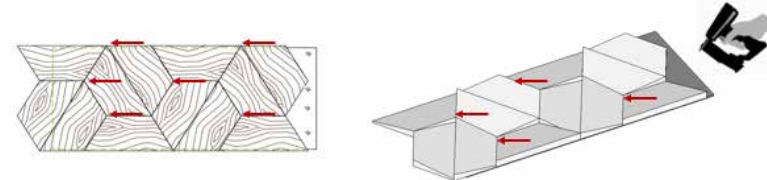

At eye level, use 23 Gauge nails, nailing in the edges of each panel.

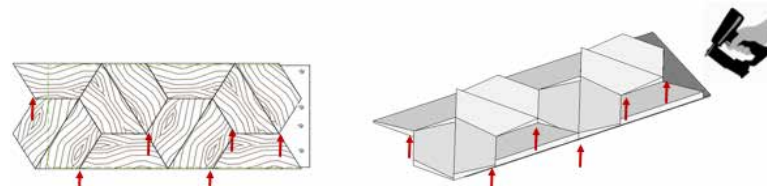

Below eye level, use 23 Gauge nails, nailing at an upward angle to avoid visible nails.

#### Step 12

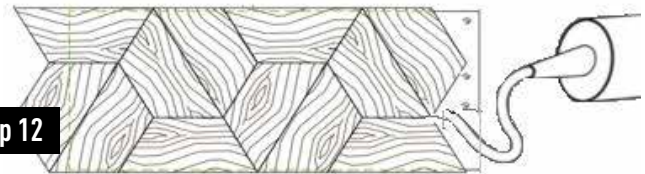

#### Step 13

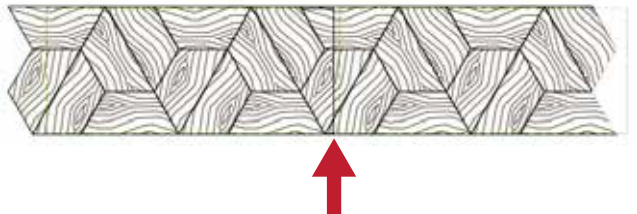
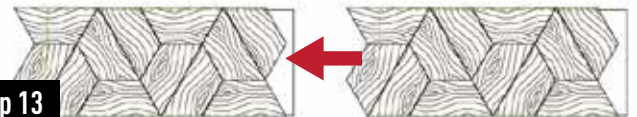

#### Step 14

Make sure each tile and row is level and plumb.

#### Step 15

Repeat the entire fastening process across the wall, making sure to cut any tiles to fit as you approach the end of the wall.

**REMEMBER:** The panels must be affixed with both glue and nails for our Warranty to apply. This also prevents panels from warping.

#### Step 11

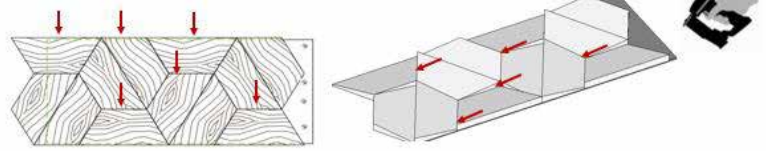

Above eye level, use 23 Gauge nails at a downward angle.

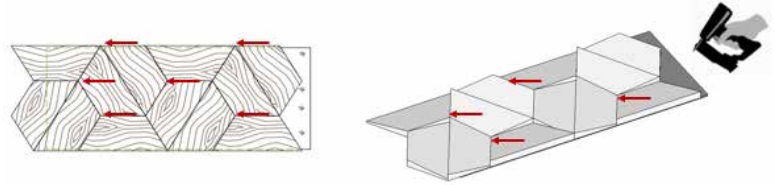

At eye level, use 23 Gauge nails, nailing in the edges of each panel.

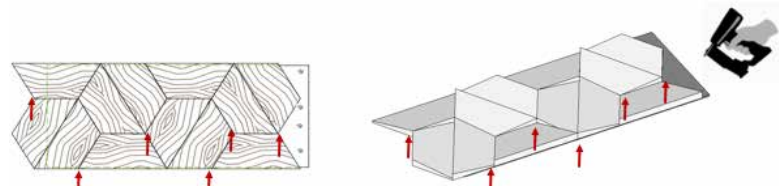

Below eye level, use 23 Gauge nails, nailing at an upward angle to avoid visible nails.

#### Step 12

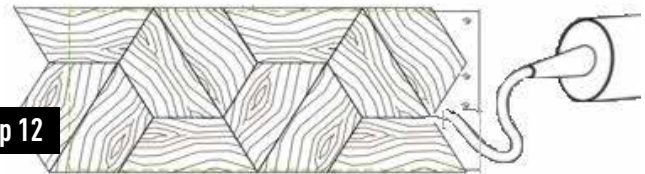

#### Step 13

